

# PRODUCT SHEET

## Description:

Maxi Hinge, Steel, NPL, 165DG, "A" ø35mm, Full-Overlay, With Mouting Plate H:2mm F/Chipboard  
Screws, ø35mm Cup, cc:45mm -, 9,5mm, Cup Height: 11,5mm, NPL, Slide-On

## Item number:

15.03.681-0

Units	Box	Carton	HS Code	Barcode
Pcs.		100	8302100090	
				5704866052894



Finishing: Steel  
Angle of opening: 165°  
Depth of hinge cup: 11.5mm  
Diameter of hinge cup: 35mm  
Hole spacing: 45mm  
Range for door thickness: 14-18mm

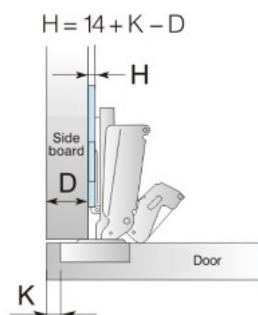
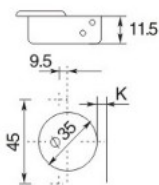

D	K	3	4	5	6	7
0	H	16	17	18	19	20
2	H	14	15	16	17	18
4	H	12	13	14	15	16

## SISO A/S

Mileparken 11  
DK-2740 Skovlunde  
Denmark  
VAT: DK24786013

Phone +45 45 830 900

[www.siso.dk](http://www.siso.dk)  
[siso@siso.dk](mailto:siso@siso.dk)

Danske Bank  
Nytorv Branch  
Copenhagen  
SWIFT: DABADKKK

Account no.  
4180 3112 112936  
IBAN Account  
DK7230003112112936